

Welcome home...

This is a Phoenix that time forgot. A roomy, luxurious 1920 Craftsman bungalow on a lot-and-a-half in the Roosevelt Historical District. A quiet, tree-lined street. A shady porch. A stately hearth. A heated pool and spa. Inside you'll find a gourmet kitchen and a huge master suite with a jacuzzi in the master bath. And yet the home has kept its historical integrity. Beautiful maple hardwood floors, double hung windows, all with Craftsman attention to detail. And a beautiful, professionally-landscaped yard. Are you exiled in some vast suburb, lost in a sea of sameness? No, you're right in the heart of town! Your home is a unique gem set in a bucolic splendor – and yet you're just a few steps away from the library, the art museum, the light rail. A simpler, better life awaits you here. Make this unrepeatable home your own...

More info, an interactive floorplan and many more photos at www.56WestWillettaStreet.com

Call Greg Swann at **602-740-7531** for a showing appointment.

Our homes are structures, shelters, domiciles. But the idea of a residence encompasses so much more than mere tentage – mere respite from heat and cold and wind and rain and the relentless summer sun. If all we needed was a place to escape the elements, we might just as well live in insulated barns.

But your home – your residence – is much more than that. It's love and marriage and family, of course, home and hearth, kith and kin. But at a more fundamental level it is a *reflection* of who you are, an enduring stake stuck into the earth that declares to all: *This is who we are, this is what we believe in and stand for and cherish.*

This is not *where* we live, not *how* we live. This structure, this shelter, this domicile – this home – *is* our lives, as much an essential part of what we are as our heads, our hands, our hearts.

Home is where the heart is? A home like this is the beating heart of lives lived wisely and well.



A classic Craftsman bungalow, spacious and luxurious...



The roomy kitchen is the heart of this home...



Charming old-world details abound throughout the home...



This is an eminently livable home, but it's also perfect for entertaining. The common spaces are vast and open, and the pool and patio could host dozens of guests. This is Downtown Phoenix at its best – a huge, shady lot in the Chelsea Place neighborhood of the Roosevelt Historic District. And you're right in the heart of everything. Even so, you'll be nestled in a cocoon of suburban bliss amidst all that bustling urbanity. Beauty, history and city life, all in your unique new home...

For more information, call Greg Swann at



Bloodhound
REALTY.COM
www.BloodhoundRealty.com
602-740-7531

The square footages and room size information are deemed to be reliable but are not guaranteed and should be independently verified.

56 W Willetta St

Pool Area

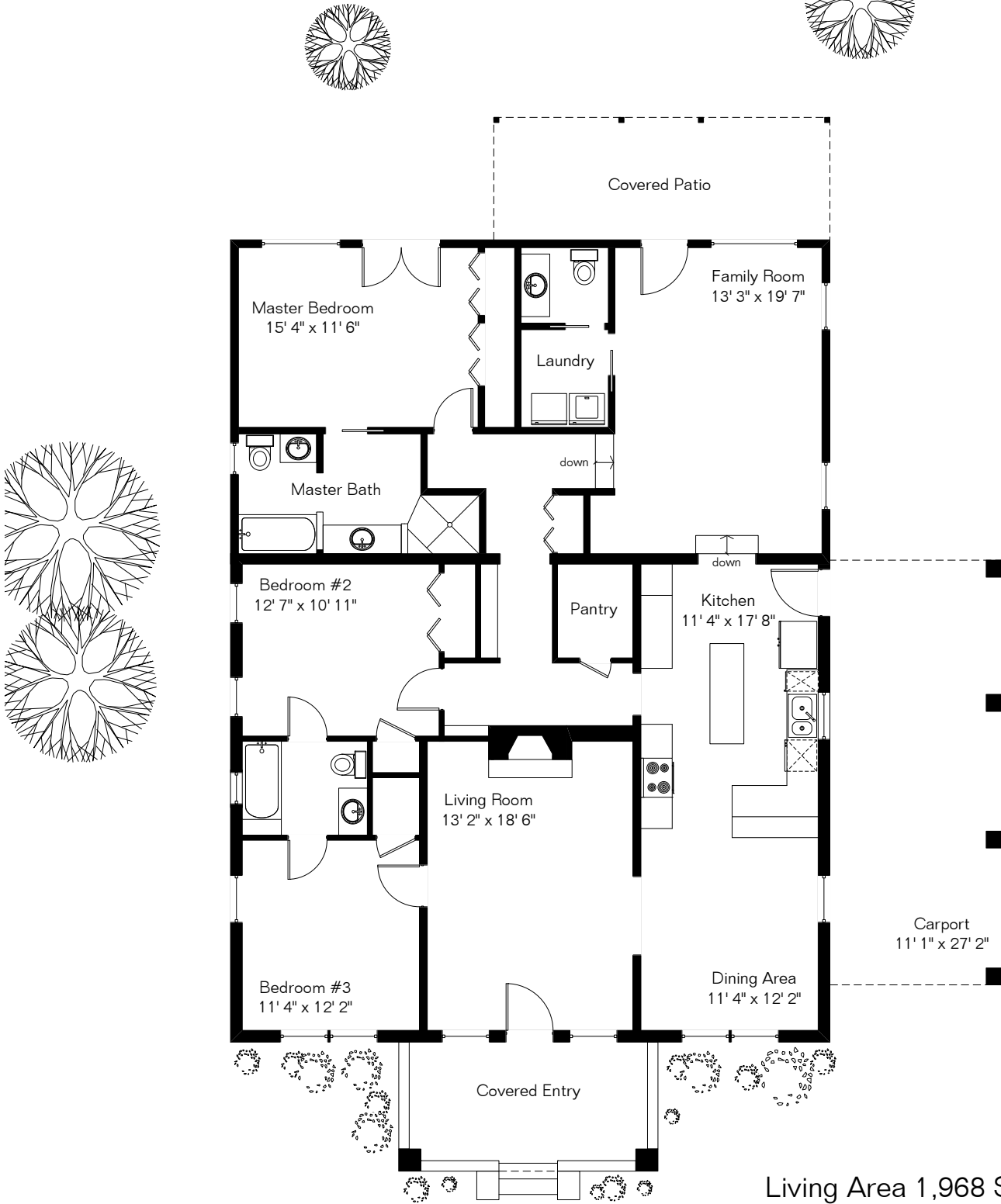

Put your furniture right where you want it!
An interactive version of this floorplan can be
found on this home's custom web site:
www.56WestWillettaStreet.com

Site Visit October 2008

0 ft. 6 ft. 10 ft. 20 ft.



Copyright 2008 Floor Plans First! LLC
All Rights Reserved.

www.FloorPlansFirst.com

Toll Free (877) 887-1500
Voice (520) 881-1500
Fax (520) 791-7701

